

## OLIS-K Profile

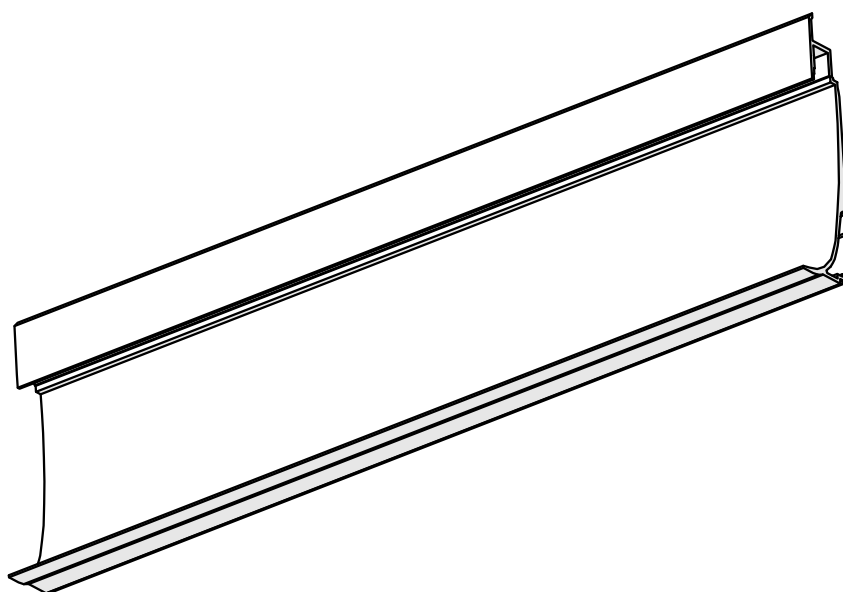

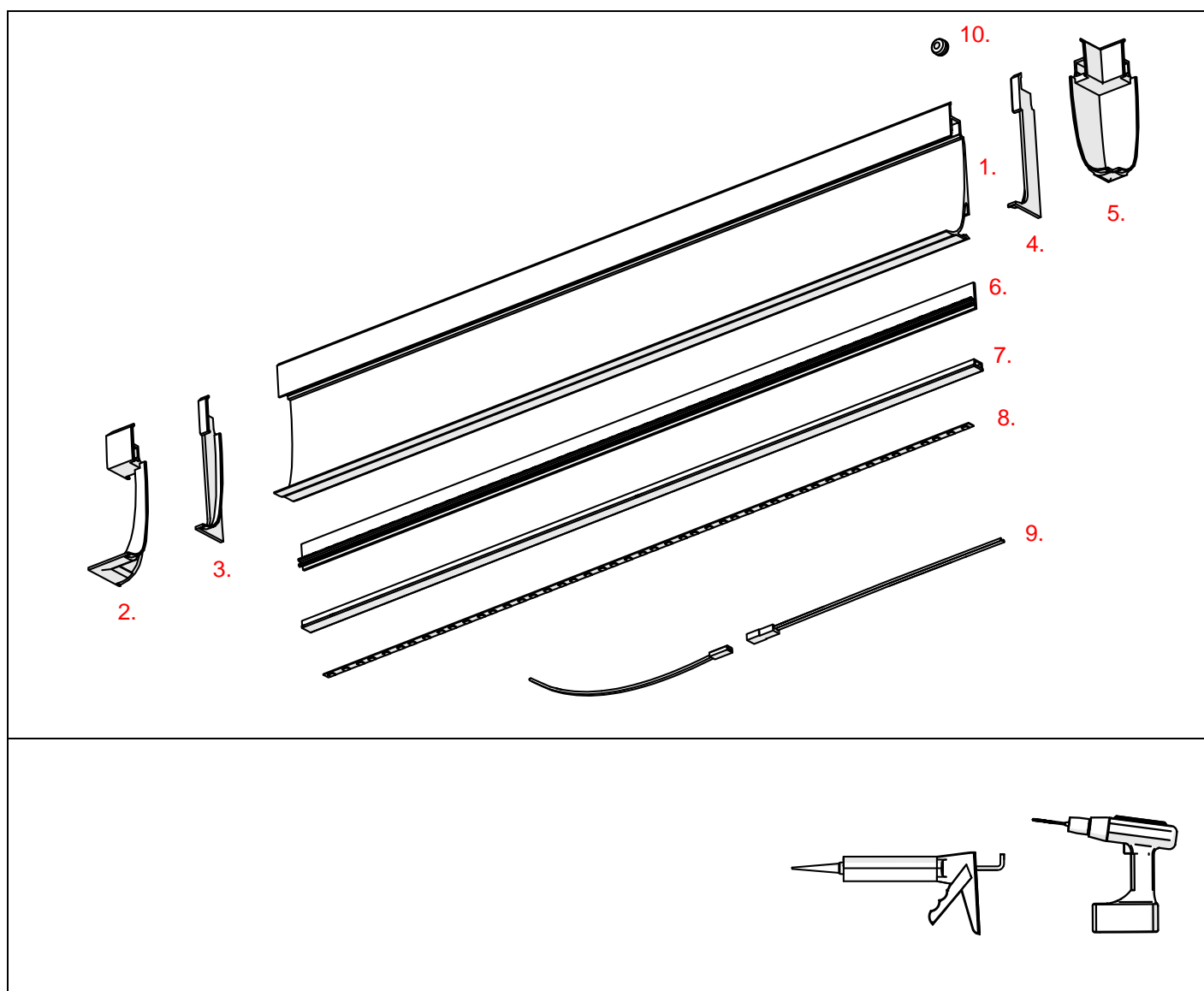

1. OLIS-K Profile (Ref. C4195)
2. OLIS-90Z End cap (Ref. C24482)
3. OLIS-K-L End cap (Ref. C24480)
4. OLIS-K-P End cap (Ref. C24484)
5. OLIS-90W End cap (Ref. C24483)
6. Connecting Strip (Ref. C24009)
7. Cover BENCO-7 (Ref. 17069)
8. LED tape\*
9. Connector
10. Gland\*

\* The full range of accessories and electronics is available at [www.KlusDesign.com](http://www.KlusDesign.com)

**NOTE! !** All LED tapes must be connected to a 12 V or 24 V power supply.

**IMPORTANT:** Not all possible mounting procedures are presented here.  
More mounting procedures and related accessories can be found at [www.KlusDesign.com](http://www.KlusDesign.com).  
Drawings in these instructions are simplified and only approximate the actual shapes.

